

1 CHOOSE YOUR FRAME



ML1
Tapered Leg



ML2
Steel Swivel Base
(zinc only)



ML3
Steel Sled Base
(Zinc base standard
Smoke available at
an upcharge)



ML4
Dome Swivel
(Platinum or
Ebony)

2 CHOOSE YOUR POWER



Manual



-PR
Power Recliner



-PRB
Power Recliner
with Battery

3 CHOOSE YOUR ARM

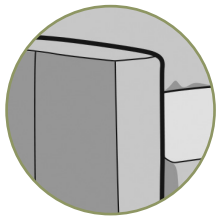

WR
Wrapped Arm
29.5" chair width

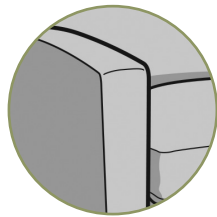

CU
Curved Arm
31" chair width

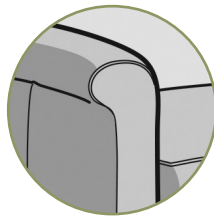

RO
Rolled Arm
32" chair width

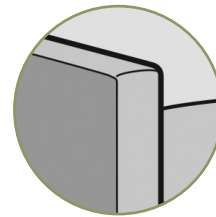

TR
Track Arm
28.5" chair width

4 CHOOSE YOUR BACK

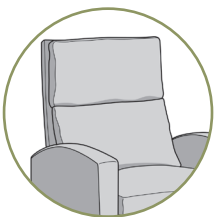

SB
Split Back

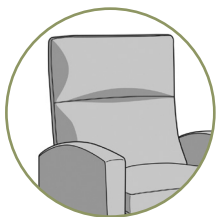

OP
One Piece Back

All lines below must be completed. One sheet per item.

Example order:

1. Frame	ML1
2. Power	PR
3. Arm	CU
4. Back	SB

Ex. Style Number: **ML1-PRCUSB**

Store:	Contact:
_____	_____
Email:	Date:
_____	_____
Purchase Order #:	Style #: (See example above)
_____	_____
Cover:	Finish:
_____	_____
Cushion Fill:	Quantity:
_____	_____